

TCP AMENDMENT

NAME: _____
 DATE: _____
 CERTIFICATION NUMBER: _____
 SIGNATURE: _____

UHF CHANNEL



LEGEND:

- WORK AREA
- TRAFFIC CONTROLLER
- PEDESTRIAN PATH
- ARROW BOARD

NOTES

TCP IMPLEMENTATION

SSTC DOES NOT ACCEPT LIABILITY FOR OR ENDORSE THE USE OF THE TCP UNLESS IMPLEMENTED DIRECTLY BY AN AUTHORIZED REPRESENTATIVE OF SSTC HOLDING VALID QUALIFICATIONS TO CARRY OUT SUCH WORKS.

VEHICLE MOVEMENT PLAN

ALL WORK VEHICLES TO ENTER AND EXIT WORKSITE UNDER THE DIRECTION OF TRAFFIC CONTROLLER WITH THE TRAFFIC FLOW ON DESIGNATED UHF CHANNEL

RECOMMENDED TAPER LENGTH

APPROXIMATE SPEED OF TRAFFIC KM/H	TRAFFIC CONTROL AT BEGINNING OF TAPER	LATERAL MERGE SHIFT TAPER	TAPER
45 OR LESS	15	0	15
46 - 55	15	15	30
56 - 65	30	30	60
66 - 75	N/A	70	115
76 - 85	N/A	80	130
86 - 95	N/A	90	145
96 - 105	N/A	100	160
> 105	N/A	110	180

TOLERANCES

POSITIONING OF SIGNS
 MINIMUM 10% LESS THAN THE DISTANCE OR LENGTHS GIVEN
 MAXIMUM 25% MORE THAN THE DISTANCE OR LENGTHS GIVEN
 SPACING OF DELINEATING DEVICES
 MAXIMUM 10% MORE THAN THE SPACING GIVEN
 NO MINIMUM

LANE WIDTHS

THE MIN LANE WIDTH TO BE PROVIDED THROUGH OR PAST THE WORKSITE SHALL BE 3.0m (3.5m DESIRABLE)

QUEUE MANAGEMENT PLAN

AT ALL TIMES DURING THE COURSE OF THE WORK TRAFFIC QUEUES SHALL BE MONITORED TO ENSURE THAT TRAFFIC DOES NOT EXCEED BEYOND THE LIMITS OF ADVANCED WARNING SIGNS

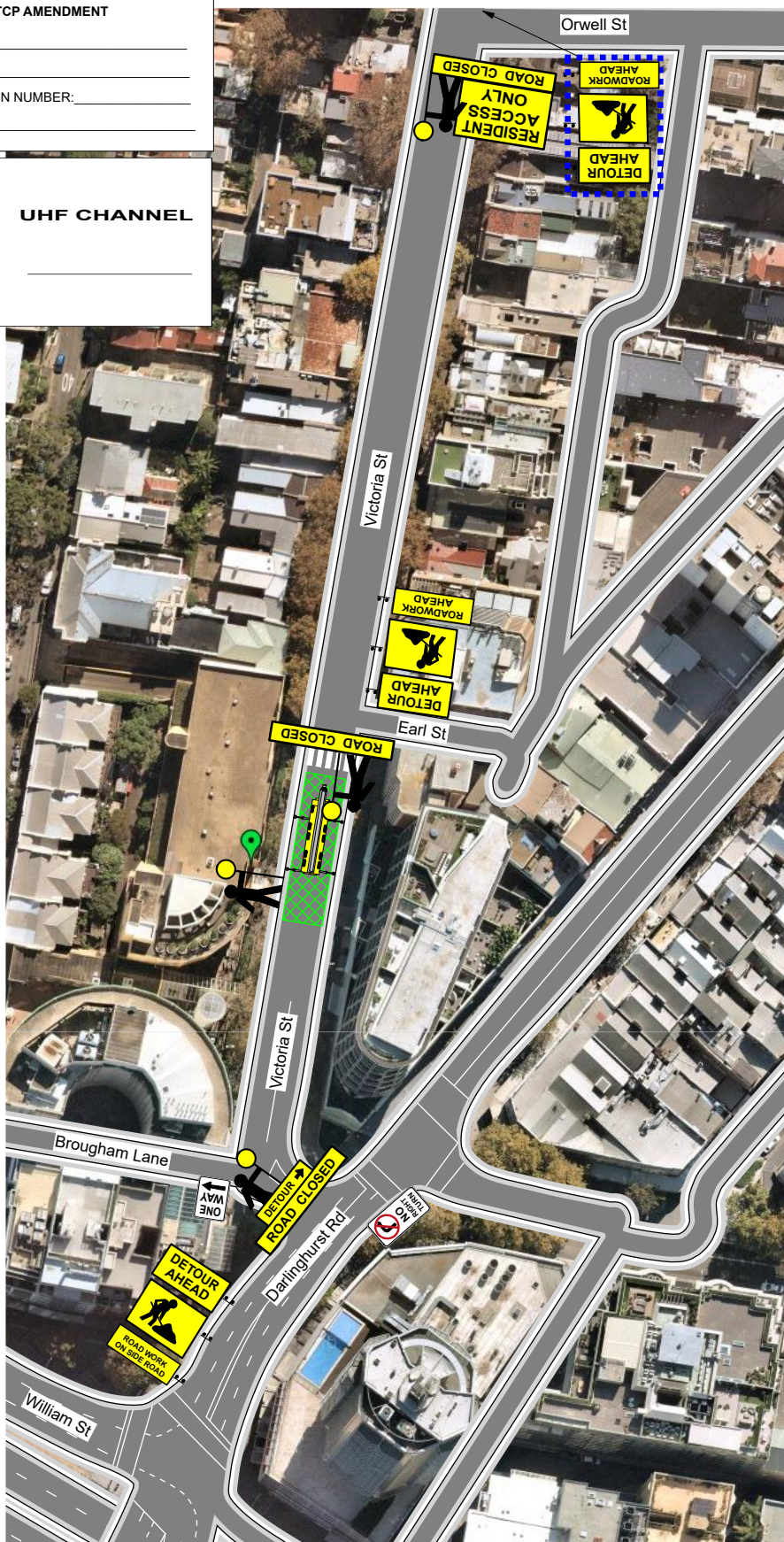

GENERAL NOTES

- THIS DRAWING IS TO BE READ IN CONJUNCTION WITH AS 1742.3.3 TOWNS 2010
- ALL TRAFFIC CONTROL DIAGRAMS TO BE READ IN CONJUNCTION WITH THE TOWNS 2010
- NON-APPLICABLE EXISTING SIGNAGE SHALL BE COVERED E.G. SPEEDS SIGNS DUE TO THE TEMPORARY SPEED ZONE
- ALL SIGNAGE DISTANCE SHALL COMPLY WITH AS 1742.3.3 TOWNS 2010
- IN ACCORDANCE WITH TOWNS 2010 TRAFFIC CONTROLLERS TO ASSIST PEDESTRIANS WITH MOVEMENT THROUGH & AROUND THE WORKSITE
- SIGNAGE SHALL BE PLACED ON THE SIDE OF THE ROAD ADJACENT TO THE TRAFFIC FLOW
- REMOVAL OF TRAFFIC CONTROL SIGNS AND DEVICES SHOULD BE UNDERTAKEN IN THE REVERSE ORDER OF ERECTION, PROGRESSING FROM THE WORK AREA OUT TOWARD THE APPROACHES

DIMENSION "D"

SPEED OF TRAFFIC KM/H	DIMENSION D-M
45 OR LESS	15m
46 - 55	15m
56 - 65	45m
66 - 75	45m
GREATER THAN 65 KM/H	EQUAL TO POSTED SPEED

Client:	BOTANY CRANES	Term:	SHORT	ROL Required:	YES	DATE PREPARED:	11/05/2020	DESIGNED BY:	TRENT STEEL
Road Name:	VICTORIA ST	Road Type:	4 LANES TWO WAY	ROL Number:	TBC	DATE REVISED:	006/12/2020 EXP 03/09/2022	TOWNS REFERENCE:	PREPARE WORK ZONE
Suburb:	DARLINGHURST	Speed Limit:	50KM/H	Road Classification:	COUNCIL ROAD	APPROVED:	Trail Steel	PLAN REF#:	00-BOT-VIC-FRC-00
T/Cs Required:	4	Travelled Path:	PAST	Speed Reduction:	N/A	DATE APPROVED:	11/05/2020		
Vehicles Required:	1	Operation:	CRANE 24	N.C.S.:	EARL ST				

BOTANY CRANES

SSTC
SITE SECURITY & TRAFFIC CONTROL

Our Values Are Our Strength